

ULTRA

MARINE PRODUCTS



ANCHORS SWIVELS CHAIN GRABS QUICKLINE

www.ultraanchors.com

ULTRA

ANCHORS



*The Ultra Anchor suits
most bow rollers
and is suitable for all
vessel types.*

"The Ultra Anchor sets within 1m – and I mean up to the shank! In one of the inlets the wind shifted 180 degrees and the anchor reset itself by turning around on its own length. We spent two days held up in a small inlet in 35 - 45 knot winds. Although my bridle parted; losing my thimble causing our Catamaran to swing wildly, the Ultra Anchor never moved according to the GPS markers. I can finally leave the boat and go on long tours, but most importantly I can sleep at night!"

Steve Dinger – S/V Tivoli 472 Catana Catamaran

"Anchoring technology has obviously come a long way from the days of using a traditional plough anchor. The design and features that the Ultra offers in comparison to other style anchors clearly sets it apart from the competition."

Silvio Pradella – Brixia Marine Pty Ltd

"We have used our anchor many many times throughout our trip and absolutely LOVE it! Our new motto is simply "drop it, set it, forget it!" We love our Ultra!"

Alexus Sheppard – Nu Moon 42' Nova Sundeck

We replaced our Lloyds approved high holding power anchor which consistently failed to hold our yacht, with the Ultra stainless steel anchor and swivel of the same weight. I am delighted to confirm that the 80kg not only looks superb, but has held my 100 ton yacht securely during 2 days of 40 knot winds with gusts up to 50 knots."

Peter Burnet – Owner of 'Spirit of the East'

Ultra Anchor - Selection Chart

Maximum Boat Weight (Tonnes)

Product Code	Anchor Weight		Powerboat	Sailboat	Catamaran		Max Vessel Length
	kg	lbs			Sail	Power	
SSUA5-11	5	11	1.6 T	1.2 T	0.8 T	1 T	6 m
SSUA8-18	8	18	2.7 T	2.0 T	1.1 T	1.4 T	7 m
SSUA12-26	12	26	4.8 T	3.6 T	2.4 T	3 T	8 m
SSUA16-35	16	35	9.3 T	7 T	4.7 T	6 T	11 m
SSUA21-46	21	46	16 T	12 T	8 T	10 T	12 m
SSUA27-60	27	60	24 T	18 T	12 T	15 T	14 m
SSUA35-77	35	77	35 T	26 T	17 T	22 T	16 m
SSUA45-99	45	99	50 T	37 T	24 T	31 T	17 m
SSUA60-132	60	132	73 T	55 T	37 T	46 T	20 m
SSUA80-176	80	176	112 T	85 T	57 T	71 T	22 m
SSUA100-220	100	220	160 T	120 T	80 T	100 T	24 m

Ultra Marine Products Pty Ltd

PO Box 1055

Oxenford

Queensland Australia 4210

Ph: (+61) 7 5644 1250

Fax: (+61) 7 5519 3529

Web: www.ultraanchors.com

Email: info@ultraanchors.com

Note: Anchor selection should be made based on vessel TYPE and WEIGHT.

ULTRA ANCHORS

Ultra Flip Swivel

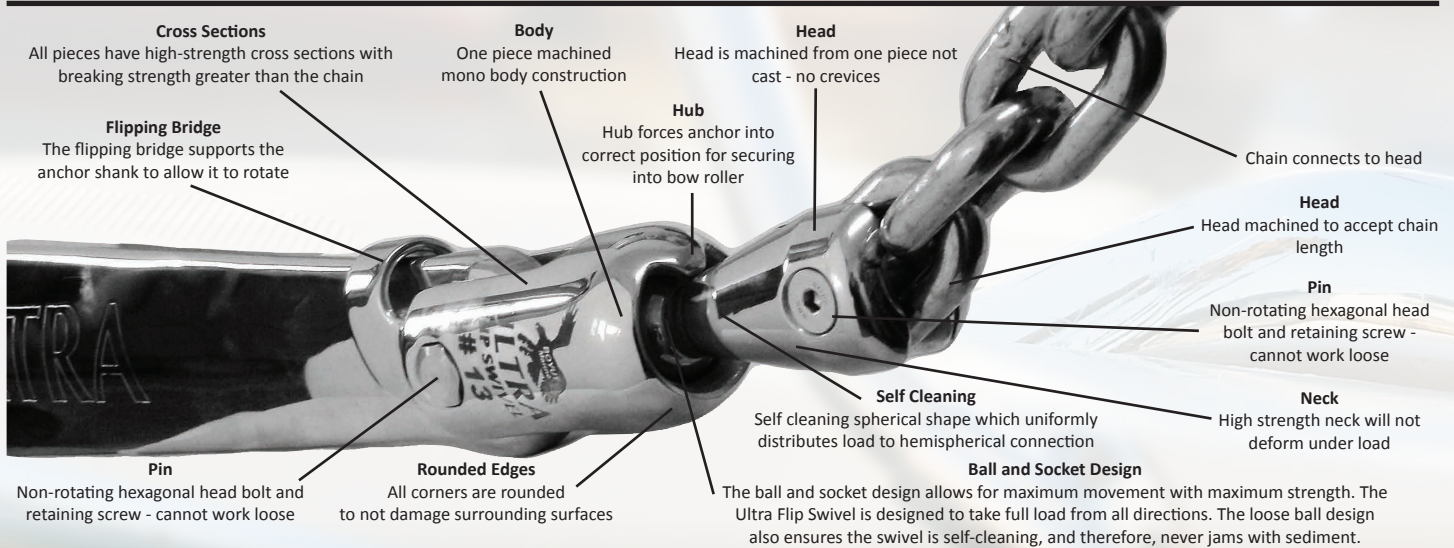

Overview

The Ultra Swivel is a uniquely fabricated anchor swivel, connecting the chain and anchor without the need of additional shackles. Fabricated from 316 stainless steel and hand polished for stunning presentation on the bow, the Ultra Swivel is uniquely strong, slimline and does not require any locking pins or safety wires.

The breaking strength of the swivel is typically higher than the chain connected and allows 30 degree rotation with complete 360 degree swivel. The Ultra Swivel is fabricated with a unique flipping nub; assisting to recover the anchor right-way up onto the bow roller. This flipping nub, combined with the Ultra Swivel's rotation and complete 360 degree swivel ability, ensures setting and recovering your anchor is an easier and safer task.

Hexagonal head locking bolts prevent the need for additional grub screws to secure the swivel pins, and every Ultra Swivel has the breaking strength listed on the rear of its one piece body.

Supplied with a standard three year warranty the Ultra Swivel incorporates unique design features and advantages, making it the world's most advanced anchor swivel.

$\alpha : 28^{\circ} - 30^{\circ}$
(Approximate)

Top View

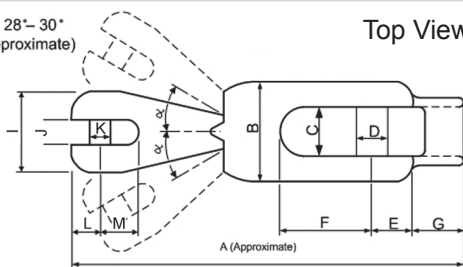

Side View

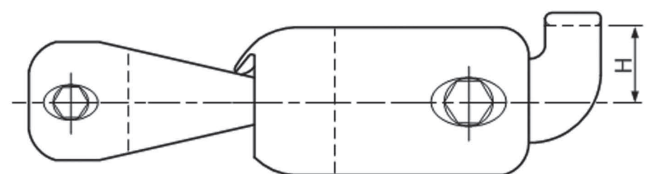

Product Code	Chain Diameter		Approx. Length	Chain Part Dimensions (mm)	Anchor Part Dimensions (mm)	Flipping Bridge Dimensions	Breaking Strength	
	mm	inch					A (mm)	I x J x K x L x M
UAS06	6	1/4"	121	25 x 7 x 7 x 9 x 11	35 x 16 x 11 x 13 x 31	14 x 17	3315	7308
UAS08	6 8	1/4" 5/16"	147	30 x 9 x 9 x 11 x 14	40 x 19 x 13 x 16 x 36	18 x 20	5630	12410
UAS10	8 10	5/16" 3/8"	168	35 x 11 x 11 x 13 x 17	45 x 21 x 14 x 18 x 40	21 x 22	8540	18830
UAS13	10 12 13	3/8" 1/2"	211	45 x 15 x 14 x 16 x 23	55 x 26 x 18 x 23 x 51	26 x 30	17510	38600
UAS16	13 14 16	1/2" 5/8"	250	53 x 18 x 18 x 20 x 27	65 x 30 x 22 x 27 x 59	33 x 36	28950	63820
UAS20	16 18 20	5/8" 3/4"	309	65 x 23 x 22 x 26 x 34	80 x 38 x 26 x 32 x 72	40 x 40	42200	93030
UAS26	20 23 26	3/4" 1"	308 (without bridge)	80 x 30 x 26 x 33 x 43	100 x 48 x 32 x 40 x 77	(No Bridge)	57900	127640

Note: Ultra Flip Swivel not recommended/compatible for use with sliding shank anchors (eg. sliding slot, rock slot, shackle slot...)

ULTRA ANCHORS

Ultra Chain Grab

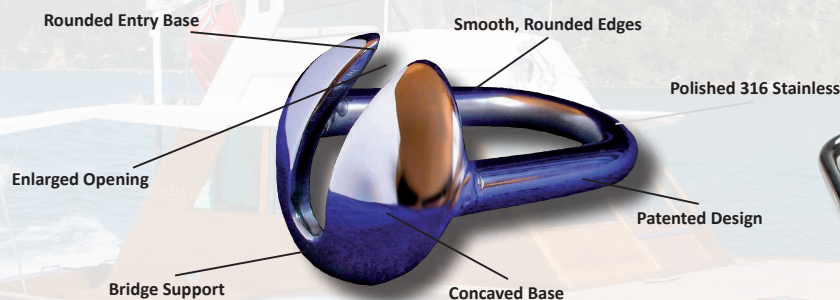

Overview

Using a snubber is always recommended when deploying an all-chain rode. Snubbers act as shock absorbers between rode and vessel, while at the same time transferring surge loading caused by wind and waves from the windlass to a deck cleat. No windlass is built to bear the load of a deployed anchor, particularly the bone-jarring snatches of an all-chain rode fetching up short.

Made from 316 stainless steel, the chain grab ensures an even load is dispersed over the chain link attached and does not weaken or stretch the link. Likewise, the snubber rope absorbs the shock, relieving stress on the anchor rode and windlass and prolonging the life of your anchor winch.

Product Code	Description	Chain Size	
		mm	inch
UCG06	Ultra Chain Grab t/s 6mm chain	6	1/4
UCG08	Ultra Chain Grab t/s 8mm chain	8	5/16
UCG10	Ultra Chain Grab t/s 10mm chain	10	3/8
UCG13	Ultra Chain Grab t/s 13mm chain	13	1/2
UCG16	Ultra Chain Grab t/s 16mm chain	16	5/8
UCG20	Ultra Chain Grab t/s 20mm chain	20	3/4

Unique Features

- **316 Stainless** – Designed to withstand any environment, the Ultra Chain Grab is fully fabricated (not cast) from 316 stainless steel and hand polished for immaculate presentation.
- **Concaved Base** – The concaved base design ensures the load is spread evenly across the chain link, avoiding potential stretching or weakening of individual chain links.
- **Bridge Support** – Provides strength to the concaved base of the chain grab ensuring it will not fail and prevents the chain link dropping off.
- **Rounded Edges** – Rounded edges and smooth corners ensure the chain grab will not catch or hook as it lowers over the bow roller and is easy on the hands.
- **Enlarged Opening** – Enables the chain grab to be easily attached to a taut anchor rode avoiding a potentially dangerous situation if conditions are unfavourable.
- **Rounded Entry** – As above, assists the chain entry into the opening ensuring the link does not catch on the entry corners.
- **Patented Design** – Uniquely designed and manufactured, the chain grab is a patented design and is the most advanced chain grab available in today's market.
- **Warranty** – The Ultra Chain Grab is supplied with a standard three year warranty.

Anchoring requirement: Is your anchoring system safe?

When checking your anchoring system, many aspects should be considered:

- Vessel size, weight, windage
- Anchor model (weight, holding power)
- Chain (size, length, chain rope combination, breaking load)
- Connection between chain and anchor, chain and vessel (swivel, shackle, rope, link...)
- Usage, cruising ground and conditions (day anchoring, overnight, remote areas, reef, ground types, weather condition, tidal area...)
- Anchor winch specification and pull capability
- Bow Roller arrangement (self launching, anchor retrieval...)
- Snubber or Bridle

PLEASE CONTACT US FOR ASSESSMENT AND RECOMMENDATION

ULTRA ANCHORS

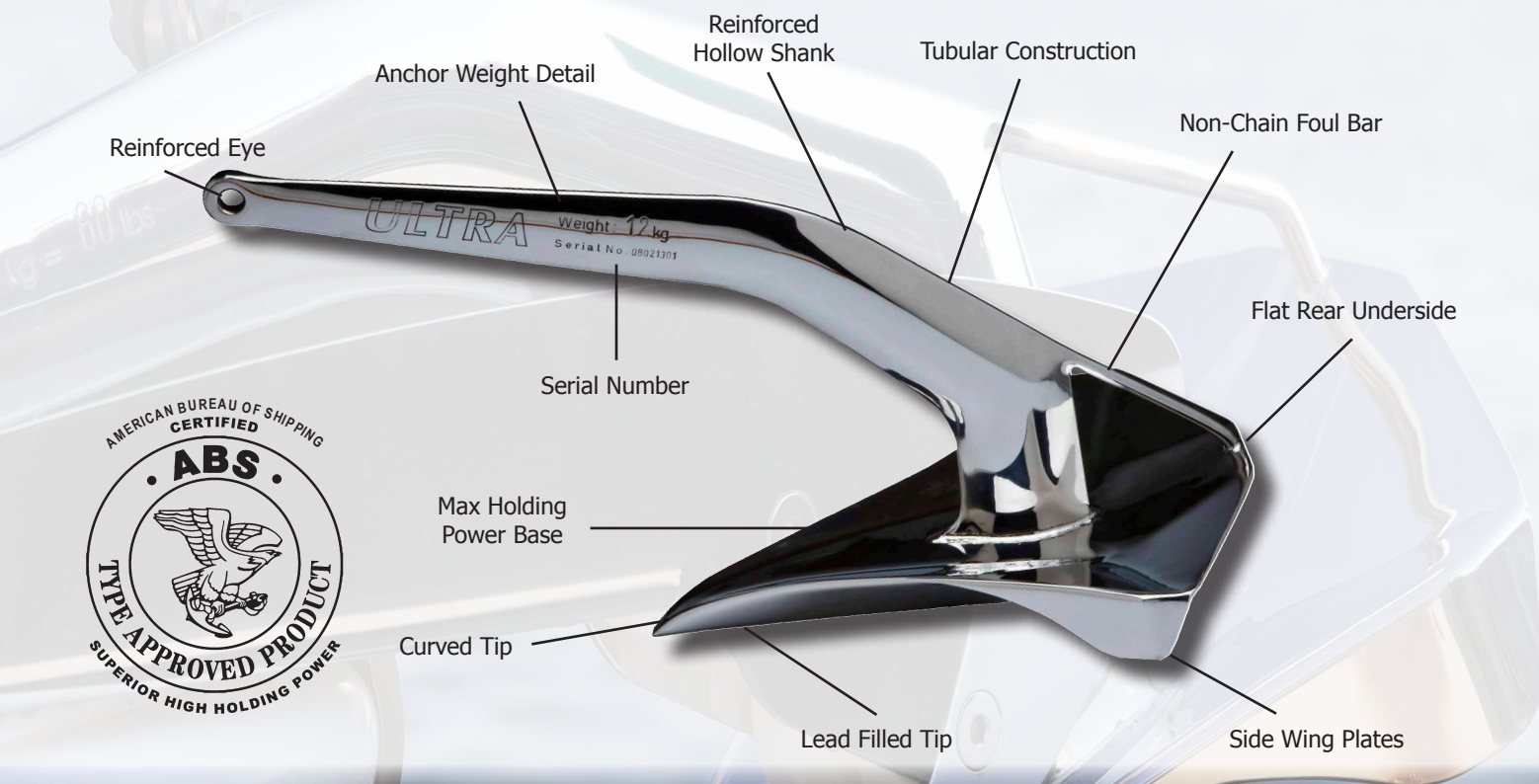

Overview

Manufactured in Europe, the Ultra Anchor range is the pinnacle in anchoring technology and design. Completely hand made from 316 stainless steel and hand polished, every Ultra Anchor is designed for excellence.

The Ultra Anchor demonstrates why a correct weight distribution and design is so important when setting and recovering your anchor. In fact, invert any Ultra Anchor and it will instantly recover itself to the attack position.

Such performance has been achieved with the innovative patented features this anchor displays; including a curved lead filled tip for instant penetration, a hollow shank for optimal weight distribution, concaved base surfaces for maximum holding power and large side wing plates to avoid release during changing wind or tide conditions. Furthermore, each anchor is easily recoverable with the flat pivot surface on the underside base.

The Ultra Anchor is suitable for all vessel types and locates securely onto the bow roller. Standard anchor sizes range from 5kg to 200kg with larger anchors available upon request.

Sourcing Europe's finest materials and fabricated by specialist engineers, the Ultra Anchor is supplied with a **LIFETIME WARRANTY** against manufacturing defects under normal conditions and use.

We don't compromise on quality or design, nor should you – protect your investment in style.

Unique Features

- **Reinforced Hollow Shank** – Enables weight to be concentrated on anchor tip.
- **Tubular Construction** – Anchor cannot lie on its spine and recovers instantly to the attack position. Anchor will also load correctly into the bow roller.
- **Lead Filled Tip** – Lead is inserted into the anchor tip, achieving the optimal weight distribution and ensuring the anchor will penetrate unfavourable bottom conditions.
- **Curved Tip** – Importantly, the anchor tip is shaped downwards, ensuring an instant set in the sea floor.
- **Max Holding Power Base** – The concaved base/fluke has the appearance of a spade or shovel, and has extreme holding power with a greater surface area than conventional style anchors. The result is a more secure, higher holding power anchor that will not release.
- **Side Wing Plates** – The Ultra Anchor does not release in a changing wind or tide, it performs a complete 180 degree rotation (while still buried) on its own length and holds firm. The side wing plates assist the anchor to perform this procedure and also act to stabilize the anchor as it penetrates the sea floor.
- **Flat Underside** – Once you begin to recover the anchor from the sea floor, it pivots itself on the flat section and begins to release (boat should be directly over anchor).
- **Non-Chain Foul Bar** – Often chain can foul around the shank of the anchor, resulting in the anchor not able to set. The clever design feature of the non chain-foul bar ensures chain simply cannot wrap around the shank and provides the ability to attach a trip line.
- **Reinforced Eye** – Even under the most extreme load the shank's reinforced eye will not bend, break or fail.
- **Anchor Weight Detail** – The anchor weight is stamped into the shank and identifies the anchor size in both kgs and lbs.
- **Serial Number** – Every Ultra Anchor is stamped with a unique serial number, ensuring your anchor is always identifiable.

ULTRA ANCHORS

Ultra Quickline Reel

Unique Features

- **Hole Guides** – Provides guide for length of line deployed and assists the flat rope to dry quickly.
- **Housing & Mounting Bolts** – Housing bolts are also incorporated into the mounting system for rail and deck mounted installations.
- **Rope Guide** – Provides an indication of the length of rope deployed.
- **Flat Rope** – Made of durable polyester, the flat rope is UV resistant and has high breaking strength. The flat rope is easy to deploy, secures well to a cleat and is compact for storage.
- **Twin Rollers** – Ensures correct entrance of flat rope into housing and dispenses excess water from rope as it passes through.
- **Winch Handle** – The multifunctional winch handle is slimline, strong and does not restrict deck space. It can be used as a tool on various deck hardware and contains a standard shaft profile.
- **Material** – Made from 316 stainless steel the reel housing is suitable for any environment.
- **Standard Winch Profile** – The Ultra Quickline Reel is manufactured with a standard winch handle profile so any winch handle can be used.
- **Warranty** – A standard three year warranty is supplied.

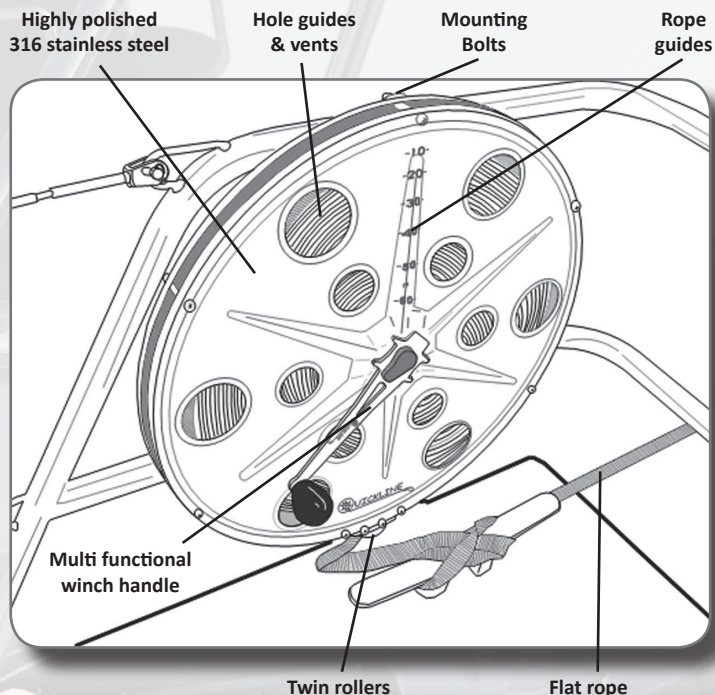

Overview

The Ultra Quickline Flat Rope & Reel is designed and manufactured in Europe as a solution for stern anchor lines, towlines or mooring lines and allows for storing a significant length of line in a compact space. The reel housing is constructed from highly polished 316 stainless steel and is available in various UV resistant line lengths ranging from 130 - 265 feet (40m - 80m).

Line deployment and retrieval is simple; simply let the line pay out as needed and wind up when done. Not to be used as a load bearing device, the flat rope must be cleated off when anchored or towing. The line is self storing and non-fouling and the flat rope means no more uninvited sea creatures on board. The rope comes with a pre-fabricated, stitched eye at one end while the other is fastened to the spool. Also included is a multi functional winch handle and comprehensive mounting kit.

Product Code	Line Length		Line Width		Breaking Force		Reel Diameter		Weight	
	m	feet	mm	inch	kg	lbs	cm	inch	kg	lbs
QSR3040	40	130	30	1.18	3000	6.850	39	15	5.5	12
QSR3060	60	200	30	1.18	3000	6.850	47	18	8.3	18
QSR3080	80	265	30	1.18	3000	6.850	54	21	10.5	23

Ultra Articulated Bow Roller



Ultra Bow Roller - Articulated

- 316 STAINLESS STEEL
- DRILLED OR UNDRILLED
- TO SUIT ANCHORS UP TO 250Kgs
- FURTHER SPECIFICATIONS AVAILABLE

Ultra Marine Products Pty Ltd

PO Box 1055 Oxenford Queensland Australia 4210

Ph: (+61) 7 5644 1250 | Fax: (+61) 7 5519 3529

Web: www.ultraanchors.com | Email: info@ultraanchors.com